



DRIVING VIDEO RECORDER DR 780 INSTRUCTION MANUAL

Scan this QR code
More information on
HELLA Driving Video Recorders

Full HD
1080



DR 780 DRIVING VIDEO RECORDER INSTRUCTION MANUAL

BASIC COMPONENTS

Main Unit	Rear Camera
Quick Start Guide	Mount Bracket
Direct Power Cable	SD Card Reader
Micro SD Card	Cable Holder
Rear Camera Connection cable	

DR 780 DRIVING VIDEO RECORDER INSTRUCTION MANUAL

PRODUCT OVERVIEW

1 LED Recording Light	7 Power Switch ON: Turn on dash camera for drive mode recording and continuous recording during park mode (ensure proper wiring). ACC: Turn on dash camera for drive mode recording, parking mode disabled. OFF: Turn off dash camera
2 Speaker	
3 GPS Connection Slot	
4 Rear Camera Connection Slot	
5 Power Connection Slot	
6 LCD Touch Screen	8 Micro SD Memory Card Slot
9 LED Recording Indicator	
10 Flip Camera Recording Angle Orientation	

DR 780 DRIVING VIDEO RECORDER INSTRUCTION MANUAL

PRODUCT SPECIFICATION

Image Sensor	Full HD CMOS Sensor
Audio input	Built-in Microphone
Video Compression	H.264
Audio Compression	ADPCM
Screen	3.5inch (480 x 320 pixels) full touch screen LCD
Micro SD Card	Up to 128 GB Micro SD Card. Format free
Resolution	Front Camera Full HD (1080p) & Rear Camera HD (720p)
FPS	Max. 30fps
Angle View	Front Camera 145 Degrees & Rear Camera 120 Degrees
G-Sensor	3axis gravity sensor, event recording by External Shock
Speaker	Operation Status alarm / Voice guidance
Wi-Fi	Built-in Wi-Fi for mobile phone application
External GPS (Optional)	Synched with Google map, Keep track of location and Speed.
PC Viewer	Windows XP/7/8/10, Support 32Bit / 64Bit Supported over OSX 10.7 64Bit Synchronizing Google map with PC viewer is supported over Windows7 and explorer 10 as per Google's policy
Power	DC 12V- 24V
Allowable current of providing fuse	3A
Operation temperature	-20°C - 70°C
Dimension	101.5mm X 63mm X 17mm (W/D/H)

DR 780 DRIVING VIDEO RECORDER INSTRUCTION MANUAL

INSTALLATION

Memory Card Insert

Please ensure Micro SD Card Memory card is inserted correctly.

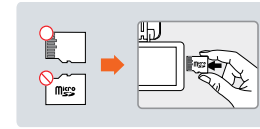

Product Installation

- Assemble the Front Camera with the Mount Bracket provided. Slide the mount bracket into the camera until a clicking sound.
- Insert the memory card into memory card slot, and peel off the adhesive tape on the bracket.
- Install the front camera at the front windshield by adjusting the angle.
- Front angle may be different depending on car brand & model. For general vehicle, install the front angle vertically.

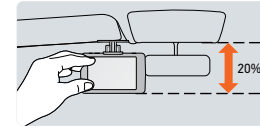

• Install the front camera so that it does not block the driver's view of vision.

DR 780 DRIVING VIDEO RECORDER INSTRUCTION MANUAL

INSTALLATION

Product Installation

- Connect wire cable to fuse box terminal in the car before connecting to dash camera.
- Peel off the adhesive tape on the rear camera and place it on the rear windshields of the car.
- It is recommended that you install the power cable towards the driver seat and rear camera connection cable towards the passenger seat to prevent interference of car navigation GPS.
- To enable Parking Mode, do ensure proper wiring is done (check with installer). Dash camera should be set to "ON".
- Setting the dash camera to "acc" will disable parking mode and over-write parking mode settings in the mobile application.

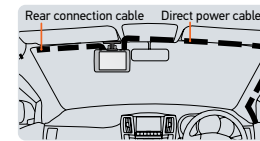
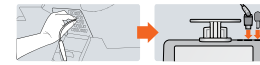

DR 780 DRIVING VIDEO RECORDER INSTRUCTION MANUAL

HOW TO USE LCD TOUCH SCREEN

Main Screen Guide

- Current date/time.
- WiFi Name.
- Videos and photos playback.
- Photo capture.
- Turn on/off voice recording.
- Configure Driver Video Recorder.
- Turn off screen. Touch screen to turn again.



DR 780 DRIVING VIDEO RECORDER INSTRUCTION MANUAL

HOW TO USE LCD TOUCH SCREEN

Icon Description

- | | |
|---|---|
| 8 GPS CONNECTION
GPS Connected.
GPS connected but no signal.
GPS not connected. | 9 Advanced Driver-Assistance Systems (ADAS)
ADAS on.
ADAS off. |
| 10 Rear Camera Connection
Rear camera connected.
Rear camera not connected. | 11 Recording Mode
Vehicle in driving mode.
Vehicle experience an impact.
Vehicle in parking mode. |

- Front camera display
- Rear camera display



FILE LIST SCREEN GUIDE

File List Screen

- Driving Records**
When the ignition is turned on, the device will begin recording automatically till the ignition is turned off. In driving mode, all video and audio recordings are saved in "Driving" folder.
- Event Records**
In the case of an impact during drive or park, event recording mode will be activated through G-sensor detector and the recorded files will be saved in "Event" folder.
- Parking Records**
If a movement is detected during parking via the motion sensor, it will activate a one-minute recording. Recording will stop after one minute.
- Photo Records**
Photo of front and rear images are saved in SD Card.
- To change order of file lists.
- To move to previous or next page.



SETTINGS SCREEN GUIDE

Settings Screen

- ADAS**
Advanced Driver-Assistance Systems.
- Video Resolution**
Selection between Full HD and HD.
- Image Quality**
Adjustment of the video frame rate.
- G-Sensor Sensitivity**
Adjust impact sensor sensitivity.
- Volume**
Touch screen and key voice volume.



- Voice Recording**
Recording of audio in video.
- Brightness**
Recording brightness.
- White Balance**
Recording white balance.
- Contrast**
Recording contrast.
- Light Exposure**
Recording light exposure.

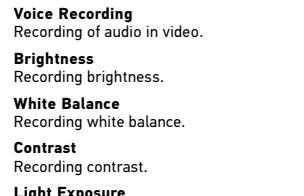

- Display Timer Setting**
Display turn off duration.
- Date and Time Setting**
Set up date and time.
- Password Setting**
Default password is "0000". Restrict access to Dash Camera recording.
- Event Alarm**
Alarm sound when an event is recorded.
- Low Battery Protection**
Disconnect dash camera when power source voltage drops to selected level.



SETTINGS SCREEN GUIDE

Settings Screen

- Parking Mode Sensor**
Impact sensor sensitivity in park mode.
- Parking Recording Duration**
Duration the dash camera will record while parked. Dash camera will automatically turn off once the time has elapsed. If "Off" is selected, recording will continue.
- Time Zone Setting**
Select time zone.
- Voice Guidance**
Enable/disable voice instructions.
- LED**
Turn on and off front LED light.
- Format SD Card**
Erase all SD card content.
- Partition SD Card**
File storage partition options for Drive, Event, Park and Photo.
- Touch Calibration**
Calibrate touch accuracy.
- Restore Factory Setting**
Revert to factory setting.
- System Information**
Show firmware version and Wi-Fi SSID.
- Self-Diagnosis**
Shows dash camera operation status.
- Online Manual**
QR code for a more comprehensive manual.



SMART PHONE CONNECTION

How to connect to Android and Apple iOS

- Search and download HELLA DR 780 application in Apple Store / Google Play Store.
- Turn on Wi-Fi function of smart phone and power up HELLA DR 780.
- Select HELLA_DR780_xxxxxx in the Wi-Fi list.
- Input password "12345678" and select "Join".
- Once connected, HELLA DR 780 will display a "Connection established" message on screen".



SMART PHONE APPLICATION

Recorded Files

- Files stored in DVR SD Card
- Video Play Back:** Select the desired clip to play back the video.
 - Download Video/Photo:** Select desired clip and click on the download button on the right. Files downloaded are found on the "Downloaded Files" tab.



Downloaded Files

- Downloaded files are stored within HELLA DR 780 application
- Video/Photo Deletion:** To delete a specific file, swipe left or press and hold. A confirmation message will appear.
 - Video/Photo Sharing:** To share or save the file within your smartphone. Press and hold the desired file for 2 seconds. Select your preferences in the pop-up window.



PC VIEWER / MEMORY CAPACITY

PC VIEWER

- Video recording can be viewed and downloaded in PC.
- Install PC Viewer using the following QR code.
- You can also download PC viewer from www.hellaasia.com



MICRO SD MEMORY CAPACITY AND RECORDING TIME

- Class 10 Micro SD card is recommended.
- It is recommended to change your Micro SD card every 6 months.

Micro SD Card Capacity	Estimated 2 Channel (Full HD + HD) Recording
16 GB	2h 30mins
32 GB	5h 15mins
64 GB	10h 45mins
128 GB	21h 45mins

PRECAUTION

Voltage Issues

- Please use recommended/stable voltage only. Otherwise, improper use may cause product failure and fire accidents, explosion or damage to the vehicle.

Installation

- Do not mount dash cam on areas where it obstructs the driver's view or the operation of the vehicle itself.
- Do not install the device on colored or heavily tinted windshield as it may affect video quality.

Usage and General Management

- Image quality could deteriorate when the temperature of the device exceeds the optimal operating temperature.
- Please check whether the device is functioning before driving a car.
- Do not remove SD card or turn off the power cable during firmware update, it may cause malfunction or loss of data.
- For safety, do not operate dash cam while driving.

Memory Card and Precaution

- SD memory card stores information in flash memory, which has a limited service life. Periodic care and checking is required.
- The device must be turned off when ejecting the memory card. It may cause loss of data or malfunction of the memory card when user forces switch-off while it is running.
- Video data may be damaged due to a defective memory card or shorten lifetime of memory card.
- Genuine memory card is recommended to avoid error, incompatibility or malfunction of the product.
- Please check your memory card once every month for maintenance and stability. It is recommended that you check memory card through SD formatter program(www.sdcard.org).
- Please do not remove the SD card while the device is running or when it is being turned off.

DISCLAIMER

- The device is not intended to be used for illegal purposes and/or surveillance. It shall not be used in any form as evidence for claim purposes.
- Some countries prohibit drivers from mounting anything on the windshield, or restrict mounting to specific areas of the windshield. It is the owner's responsibility to mount the device in compliance with local laws.
- Errors may occur depending on the surrounding environment and the voltage of the car.
- Please check date / time if the device is not used for a long period of time.
- Though this product records and saves footages in the event of accident, it does not guarantee every single accident scenes are fully recorded.
- Accident scenes may not be recorded if there is minor impact on the vehicle as the impact sensor may not be able to detect.
- HELLA is not liable/responsible for non-recorded event, missing files, etc.
- In the event that the product is used as proof of accident, HELLA will not be responsible for any gain or loss caused by the accident.